

DEIMOS S2

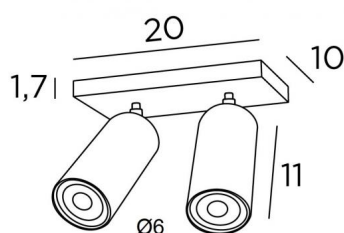

DEIMOS S2 # in brushed brass (code 25)



DEIMOS S2 # is a ceiling light with two spotlights on a rectangular base. This luminaire is prestigious, it is elegant and it has a nice presence. Easy to install, he is a must for adding more light to your home. To increase its efficiency, there are GU10 bulbs on the market with very high power and dimmable **DEIMOS** is a large cylindrical spotlight that completely encloses the bulb. A decorative black ring is placed around and behind the bulb. He is mounted on a ball joint, integrated into the cylinder of the spotlight. This spotlight is presented in a superb range of seven models, with one to three spots, spread on round, square or rectangular bases. Traditionally handcrafted by expert workers in brass, this luminaire is available in a number of remarkable finishes

OVERALL SIZES

H10→14cm

BASE : 20 x 10 x 1,7cm

TECHNICAL DATA

Two spotlights mounted on 360° adjustable joints

Spotlight dimensions : Ø6cm L11cm

Two GU10 fittings

Black decorative rings to be placed around and behind the bulbs

No driver, this luminaire is dimmable and works directly on 230V

A fixing plate for the ceiling box ([plan in PDF](#))

Mandatory use of LED bulbs (safety)

AVAILABLE METAL FINISHES AND CODES



01 - Structured white - 5128 001

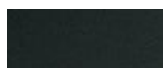

02 - Structured black - 5128 002



25 - Brushed brass - 5128 025



29 - Brushed bronze - 5128 029



45 - Structur.black-Brush.brass - 5128 045



LIGHTING COLLECTION